

CONTENTS

- 1. INTRODUCTION
- 2. PRODUCT OVERVIEW
- 3. CERTIFICATION
- 4. USE IN THE VEHICLE
- 5. CONTACT
- 6. SAFETY NOTES
- 7. INSTALLATION IN THE VEHICLE
- 8. ADJUSTING THE INCLINATION
- 9. USE IN THE VEHICLE
- 10. CLEANING
- 11. DISASSEMBLY AND DISPOSAL

1. INTRODUCTION

We are pleased that our BABY-SAFE i-SIZE BASE / FLEX BASE may accompany your child safely through the first months of his or her life.

⚠ In order to protect your child correctly, the BABY-SAFE i-SIZE BASE / FLEX BASE must always be used and installed as described in these instructions. Please read the user instructions carefully before you use the BABY-SAFE i-SIZE BASE / FLEX BASE for the first time, and keep these instructions in the space provided on the base station.

These instructions use the following symbols stated below:

| Symbol | Keyword | Explanation |
|--------|-----------------|--------------------------------|
| | DANGER! | Risk of severe personal injury |
| | WARNING! | Risk of minor personal injury |
| | CAUTION! | Risk of material damage |
| | TIP! | Useful notes |

Instructions that follow a set sequence are numbered.
Example:
1. Press the button...

2. PRODUCT OVERVIEW

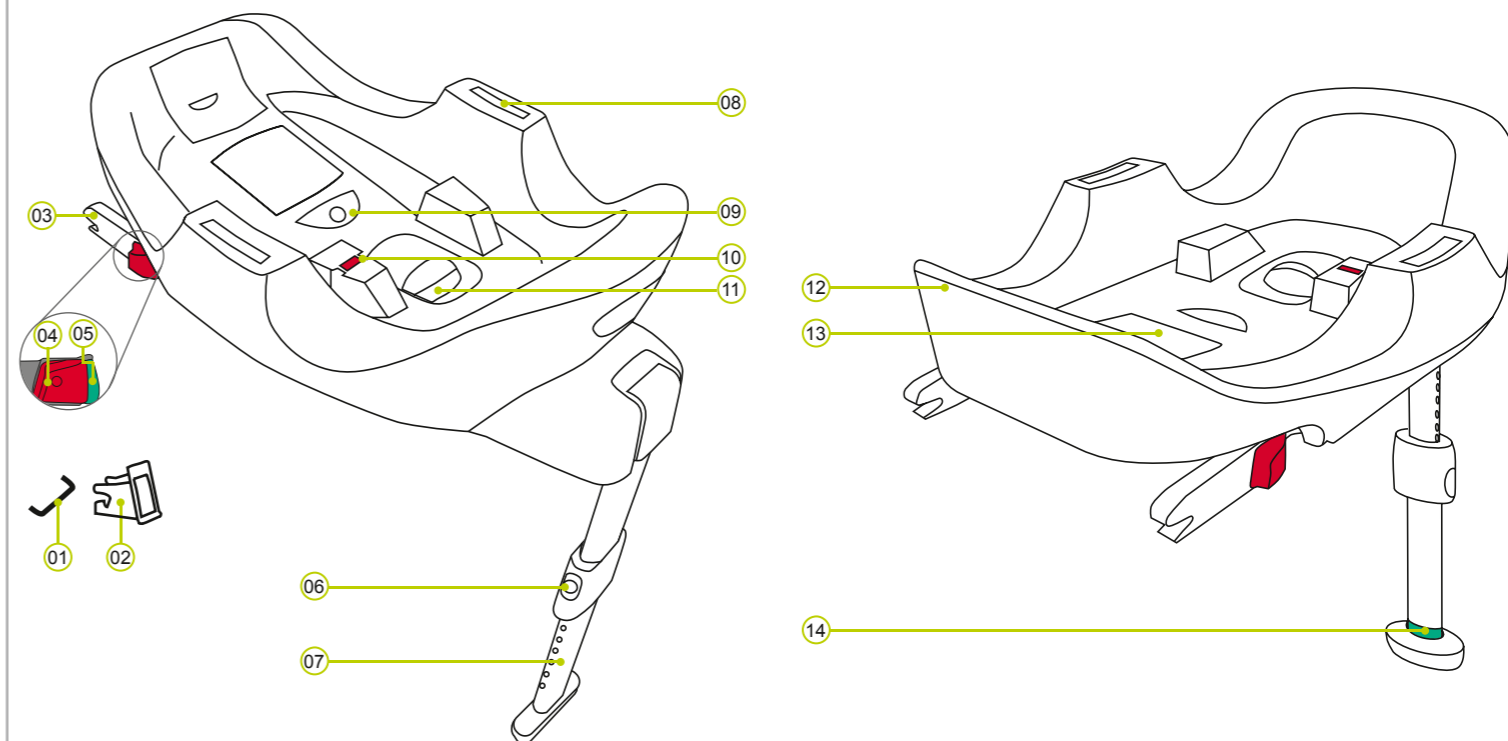

- 01 ISOFIX fastening points (car)
- 05 Safety button
- 09 Tilt adjustment button
- 13 Instruction storage compartment
- 02 ISOFIX insertion aids
- 06 Adjustment button
- 10 Tilt indicator
- 14 Support leg mark
- 03 ISOFIX locking arms
- 07 Support leg
- 11 Locking arm release button
- 04 Release knob
- 08 Fixation slots
- 12 Top part of the base station

3. CERTIFICATION

The BABY-SAFE i-SIZE BASE / FLEX BASE is only intended for use in combination with the Britax Römer BABY-SAFE i-SIZE / BABY-SAFE² i-SIZE child seat, and exclusively to secure your baby in your vehicle.

| BRITAX RÖMER child safety seat | Tested and certified according to ECE* R 129/00 | |
|-----------------------------------|---|-------------|
| | Body size | Body weight |
| BABY-SAFE i-SIZE BASE / FLEX BASE | 40 - 83 cm | ≤ 13 kg |

*ECE = European Standard for Child Safety Equipment

The child safety seat has been designed, tested and certified according to the requirements of the European Standard for Child Safety Equipment (ECE R129/00). The seal of approval E (in a circle) and the approval number are located on the orange approval label (sticker on the child safety seat).

- ⚠ DANGER!** None of the base stations may be used in combination with other infant carriers.
- ⚠ DANGER!** This approval will be invalidated if you make any modifications to the child safety seat. Only the manufacturer is permitted to make modifications to the child safety seat. Unauthorised technical changes can cause the protective function of the seat to be reduced or completely eliminated.
- ⚠ WARNING!** Use the BABY-SAFE i-SIZE BASE / FLEX BASE exclusively for securing your child in your vehicle. The base station is in no way suitable as a seat or toy in the home.

4. USE IN THE VEHICLE

Please observe the instructions for using children's restraining systems in the operating instructions of your vehicle.

Please refer to **the operating instructions for your vehicle for information about vehicle seats** which are certified for the use of children's restraining systems according to ECE R16.

Usage options for the BABY-SAFE i-SIZE BASE / FLEX BASE:

| BRITAX RÖMER child safety seat | Vehicle seating position | |
|---|--------------------------|------------|
| | i-Size | Not i-Size |
| BABY-SAFE i-SIZE BABY-SAFE ² i-SIZE (infant carrier) | ✓ | ✓ |
| + BABY-SAFE i-SIZE BASE | ✓ a) | ✓ b) |
| + BABY-SAFE i-SIZE FLEX BASE | ✓ | ✓ b) |

- a) When choosing a base station for your vehicle, please observe the recommendations in the enclosed vehicle type list (included with the base station). The type list is consistently kept up to date. The latest version can be obtained from us or at www.britax.com.
- b) This means that the base station may only be used in vehicles which are listed in the vehicle type list (included with the base station). The type list is consistently kept up to date. The latest version can be obtained from us or at www.britax.com.

You can use your base station as follows:

| | |
|---------------------------------|-------------------|
| in the direction of travel | no |
| against the direction of travel | yes |
| with 2-point belt | no |
| with 3-point belt | no |
| on front passenger seat | yes ¹⁾ |
| on outer rear seat | yes |
| on centre rear seat | yes |

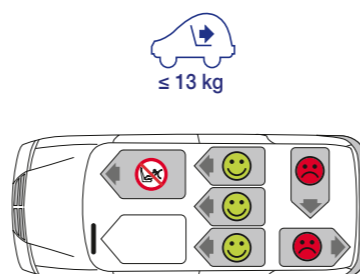

1) The front airbag must be deactivated. Observe the instructions in the vehicle owner's manual.

5. CONTACT

If you have any further questions regarding the use of the carrier, please feel free to contact us:



BRITAX RÖMER
Kindersicherheit GmbH
Theodor-Heuss-Straße 9
89340 Leipheim
Germany

T.: +49 (0) 8221 3670 -199/-299
F.: +49 (0) 8221 3670 -210
E.: service.de@britax.com
www.britax.com

BRITAX EXCELSIOR LIMITED
1 Churchill Way West
Andover
Hampshire SP10 3UW
United Kingdom

T.: +44 (0) 1264 333343
F.: +44 (0) 1264 334146
E.: service.uk@britax.com
www.britax.com

≤ 13 kg



BABY-SAFE i-SIZE BASE
BABY-SAFE i-SIZE FLEX BASE

GB

User instructions

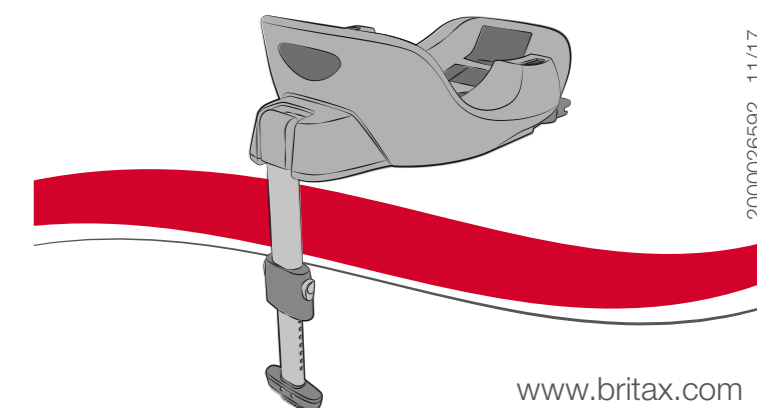

www.britax.com

2000026592 11/17

6. SAFETY NOTES

⚠ DANGER! Please take the time to read these instructions carefully and keep them to hand in the designated storage compartment (13) on the base station at all times! The instructions must be kept with the base station if the latter is passed on to a third party.

⚠ DANGER! For the protection of your child:

- In the event of an accident with a collision speed of more than 10 km/h, the base station may be damaged without the damage becoming immediately visible. In this case the base station must be replaced. Please dispose of it properly.
- As a rule, have your base station checked if it was damaged (e.g. if it falls on the ground).
- Regularly check all important parts for damage. Ensure that all mechanical parts, in particular, are fully functional.
- Never lubricate or oil parts of the base station.
- Never leave your child unattended in the infant carrier and base station in the vehicle.
- Park in such a way that you can always stand on the pavement when you place the infant carrier in the vehicle or take it out.
- Protect the infant carrier and the base station from intensive direct sunlight when they are not in use. The infant carrier can get very hot in direct sunlight. Children's skin is sensitive and could be harmed.
- The more snugly the belt fits over your child's body, the better they will be protected. Therefore, avoid putting thick clothes on your child under the belt.
- The installation and warning stickers are an important part of the base station and must not be removed.
- The infant carrier is not intended to hold your baby for prolonged periods of time. The semi-recumbent position in the infant carrier will always put a strain on your baby's spine. Take your baby out of the infant carrier as often as possible – this includes interrupting long car rides. Do not keep your baby in the infant carrier once it has been removed from the car.
- Lock the backrests of the vehicle seats (for example, engage the latch on the foldable rear seat bench).
- Never try to secure a baby on your lap with the vehicle seat belt or by holding onto them.
- Do not place objects in the footwell in front of the base station support leg.

⚠ DANGER! For the protection of all vehicle occupants:

In the case of an emergency stop or an accident, unsecured persons or objects may cause injury to other vehicle occupants. Please always check that:

- the backrests of the vehicle seats are locked (i.e. that any foldable rear seat bench latch is engaged).
- all heavy or sharp-edged objects in the vehicle (e.g. on the parcel shelf) are secured.
- all persons in the vehicle have their seatbelts fastened.
- the child safety seat is always secured when it is in the vehicle, even if no child is being transported.

⚠ WARNING! For your protection when handling the child seat:

- To avoid damage, ensure that the base station is not jammed in between hard objects (car door, seat rails, etc.).
- Keep the base station in a safe place when it is not in use. Do not place any heavy objects on the base station and do not store it directly next to sources of heat or in direct sunlight.

⚠ CAUTION! To protect your vehicle:

- Certain car seat covers made from more sensitive materials (e.g. velour, leather, etc.) may sustain signs of wear and tear when using child safety seats. For optimum protection of your car seat covers, we recommend using the BRITAX ROMER car seat protector from our range of accessories.

7. INSTALLATION IN THE VEHICLE



⚠ DANGER! An airbag hitting the infant carrier can cause serious injuries to your baby, possibly resulting in death. Do not use the infant carrier and base station in passenger seats with activated front airbags! For seats with side airbags, please observe the instructions in your owner's manual.

Preparatory activities:



1. If your vehicle is not fitted with ISOFIX insertion aids as standard, clamp the two ISOFIX insertion aids (02), which are included in the scope of delivery of the seat*, with the cutout pointing upwards to the two ISOFIX fastening points (01) of your vehicle.
 - ⓘ **TIP:** The ISOFIX fastening points are located between the surface and the backrest of the vehicle seat.

* The insertion aids facilitate the installation of the child safety seat with the use of the ISOFIX fastening points and prevent damage to the car seat covers. If the insertion aids are not being used, remove them and keep them in a safe place. For vehicles with a foldable backrest, the insertion aids need to be removed before folding the backrest. Any problems which occur are usually caused by dirt or foreign objects on the insertion aids and on the hooks. Remove soiling or external objects to rectify such problems.

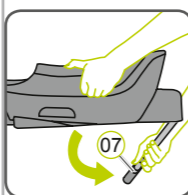

2. Rotate the support leg (07) outwards until it stops.

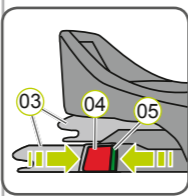

3. Push the green safety button (05) and the red release button (04) on both sides of the seat towards each other. This ensures that both hooks on the ISOFIX locking arms (03) are open and ready to use.

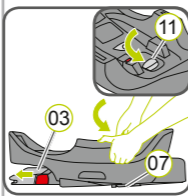

4. Pull the grey lever (11) towards the support leg (07) until the ISOFIX locking arms (03) are fully extended.

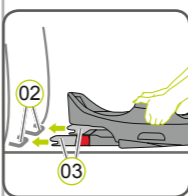

5. Place the base station against the direction of travel on a suitable vehicle seat.

ⓘ **TIP:** Depending on the design, there could be a gap between the contact surface of the base station and the vehicle seat. This does not present a safety problem when using the base station.

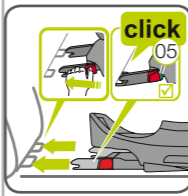

6. Position the two ISOFIX locking arms (03) directly in front of the two insertion aids (02).
7. Push both ISOFIX locking arms (03) into the insertion aids (02) until the ISOFIX locking arms (03) engage on both sides with a clicking sound.

⚠ DANGER! The green safety button (05) must be visible on both sides in order for the base station to be properly fastened.

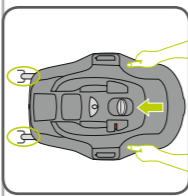

8. Take hold of the base station with both hands and push it with equal pressure on both sides towards the vehicle backrest until the base station is touching it.

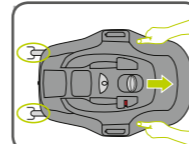

9. Pull on the base station to check it is engaged on both sides.

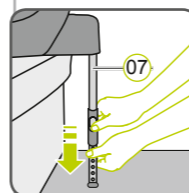

10. Ensure that the support leg (07) is fully rotated; the red mark at the top of the support leg (07) must no longer be visible.

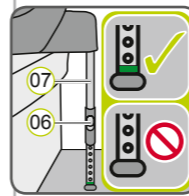

11. Press both grey adjustment buttons (06) and pull the support leg (07) out until it is secured against the vehicle floor and the green mark (14) is fully visible.
 - ⚠ DANGER!** The green mark (14) must be fully visible on the support leg (07). The support leg (07) must never be suspended in mid-air or supported by other objects. Ensure that the support leg (07) does not lift the base station from the seat.

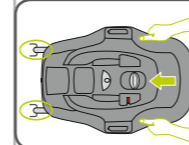

12. Only **BABY-SAFE i-SIZE FLEX BASE:** Follow the steps in chapter "8. Adjusting the inclination".
13. Take hold of the base station with both hands and push it with equal pressure on both sides towards the vehicle backrest until the base station is touching it.

⚠ For the safety of your child, before every journey in the car check that:

- ▶ the ISOFIX locking arms (03) are fully engaged on both sides in the ISOFIX fastening points (01) and that both safety buttons (05) are fully green,
- ▶ the support leg (07) rests firmly on the vehicle floor, and the green mark (14) on the support leg foot is visible,
- ▶ the support leg (07) does not lift the base station from the seat,
- ▶ the infant carrier is fully engaged in the base station,
- ▶ the infant carrier is only installed on the front passenger seat if no front airbag can strike the infant carrier,
- ▶ the infant carrier is fastened against the direction of travel.

8. ADJUSTING THE INCLINATION

Depending on the vehicle model, there can be differences in the vehicle seat inclination which can have an impact on your child's seating position. It is always recommended that the seating position be as upright as possible. You should therefore set the inclination to be only as flat as your child's constitution requires.

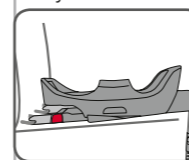

To adjust the inclination:

1. Park your vehicle on as flat a surface as possible.
2. Press and hold the grey inclination adjustment button (09) and, at the same time, pull the top part of the base station (12) gradually upwards. Every time it clicks into the next level, check if the inclination is sufficient.

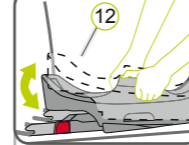

⚠ DANGER! When swivelling the top part of the base station (12) down, ensure that you do not trap your fingers.

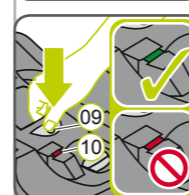

3. Set the inclination so that the inclination indicator (10) is green.

⚠ DANGER! The base station cannot be used if the inclination indicator (10) is red.

4. Release the grey inclination adjustment button (09) and check that the top part of the base station is properly engaged.

⚠ DANGER! When installing the base station in another vehicle, the inclination must again be adjusted from the flattest position.

⚠ For the safety of your child, before every journey in the car check that:

- ▶ the ISOFIX locking arms (03) are fully engaged on both sides in the ISOFIX fastening points (01) and that both safety buttons (05) are fully green,
- ▶ the support leg (07) rests firmly on the vehicle floor, and the green mark (14) on the support leg foot is visible,
- ▶ the support leg (07) does not lift the base station from the seat,
- ▶ the infant carrier is fully engaged in the base station,
- ▶ the infant carrier is only installed on the front passenger seat if no front airbag can strike the infant carrier,
- ▶ the infant carrier is fastened against the direction of travel.

9. USING THE INFANT CARRIER

Fitting the infant carrier to the base station

⚠ DANGER! Ensure that the handle (15) is in the upper position A.
⚠ DANGER! Ensure that the top surface of the base station (12) is free of foreign bodies.

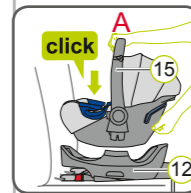

1. Place the infant carrier against the direction of travel on the base station (baby is facing backwards).
2. Snap the infant carrier into place so that it makes an audible clicking sound.
3. Check if the indicators are green on both sides.
 - ⚠ DANGER!** The indicators must be green on both sides.
4. Pull on the infant carrier handle (15) to check it is fully engaged.

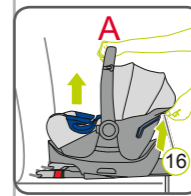
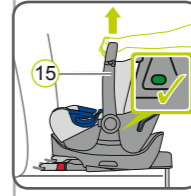

Removing the infant carrier from the base station

⚠ DANGER! Ensure that the handle (15) is in the upper position A.

1. Pull and hold the grey release latch (16).
2. Lift the infant carrier until the fixation prongs (17) release from the fixation slots (08).

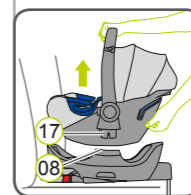

⚠ WARNING! Keep a firm grip on the infant carrier while doing this.

3. Remove the infant carrier from the base station.

10. CLEANING

The **plastic parts** can be cleaned using soapy water. Do not use harsh cleaning agents (such as solvents).

11. DISASSEMBLY/DISPOSAL

REMOVAL:

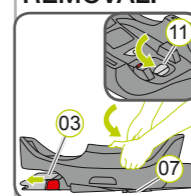

Opening the ISOFIX

1. Pull the grey lever (11) towards the support leg (07).
2. Push the green safety button (04) and the red release button (05) on both locking arms (03) towards each other. The locking arms release.
3. Pull the grey lever (11) towards the support leg (07) and press both locking arms (03) at the same time towards the support leg until they are fully retracted.

▶ The base station can now be removed.
⚠ DANGER! The child safety seat must always be secured when it is in the vehicle, even if no child is being transported.

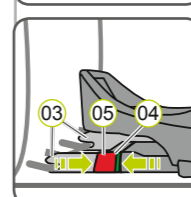

DISPOSAL:

Please observe the waste disposal regulations in your country.

| | |
|-----------------------|---|
| Disposal of packaging | Container for cardboard boxes |
| Seat cover | Residual waste, thermal utilisation |
| Plastic parts | According to the labelling in the corresponding container |
| Metal parts | Container for metals |
| Belt straps | Container for polyester |
| Buckle and tongue | Residual waste |